



Creating an Edible Landscape

East Multnomah Soil & Water Conservation District

Why create an edible landscape?



Backyard garden harvest

- ✓ Eat fresh food!
- ✓ Know how it's grown
- ✓ Family time
- ✓ Connect to nature & food systems
- ✓ Build resilient communities

Elements of an Edible Landscape

Site assessment

Edible plants by type & zone

Planning for abundance

Break

Soil & water

Integrated pest management

Beneficial insects & companion planting

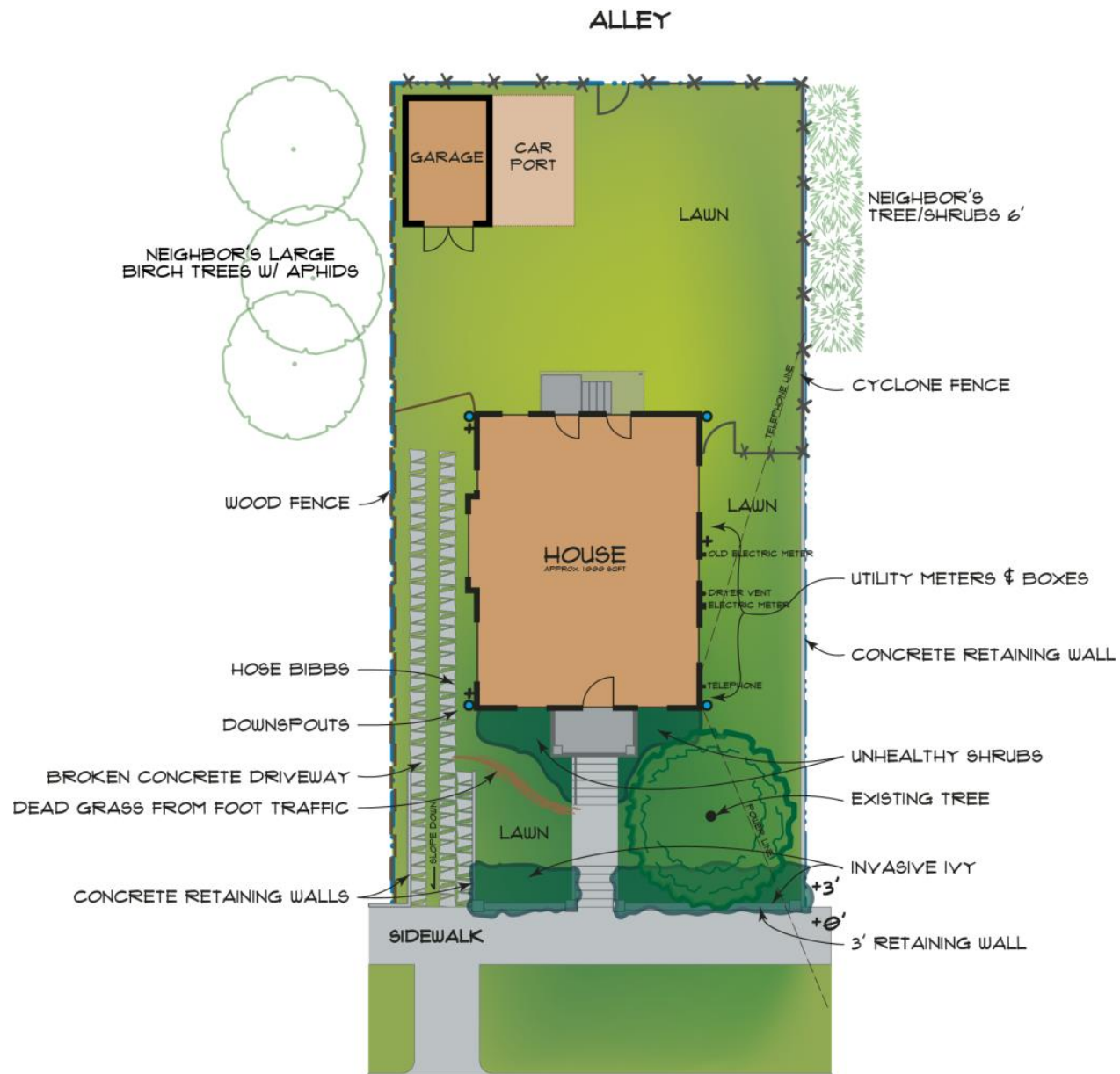

EXISTING CONDITIONS

1' 5' 10'



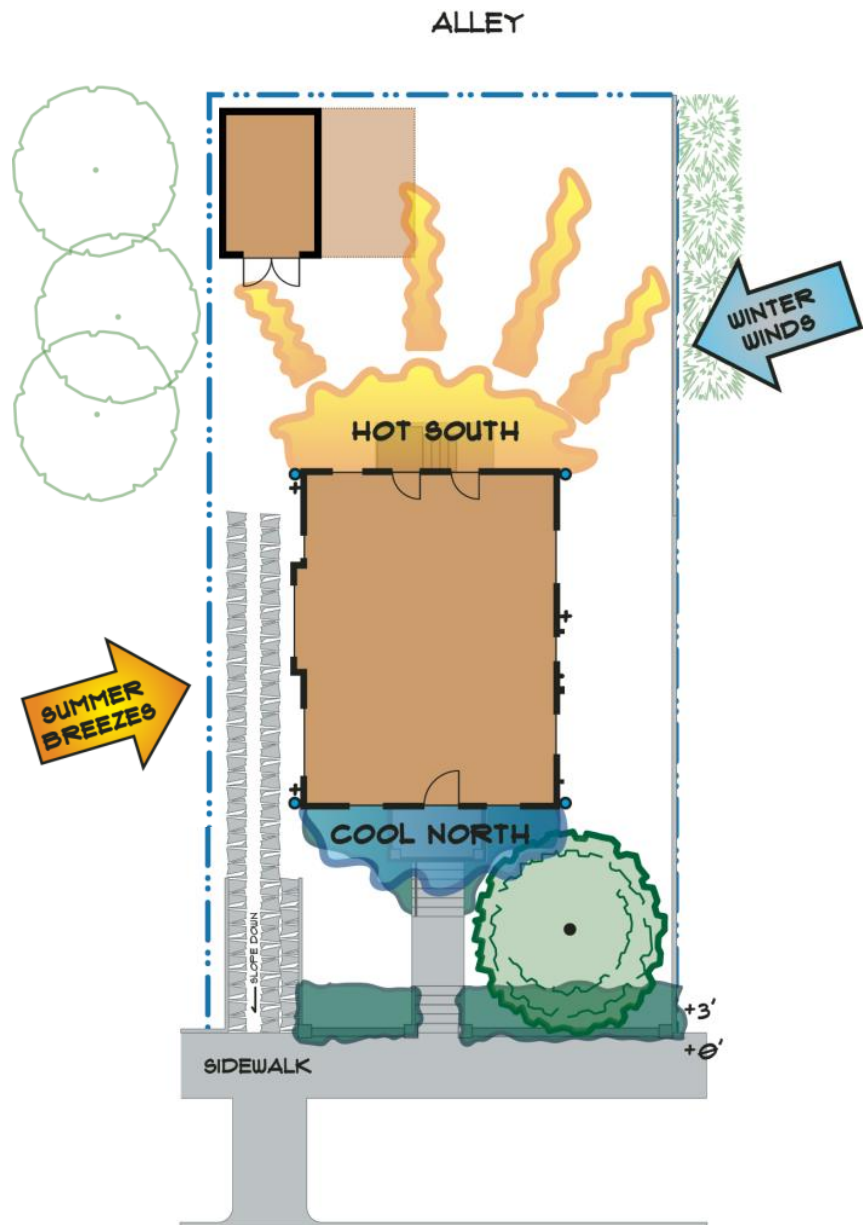

SITE ASSESSMENT: EXPOSURE

1' 5' 10'



Zones

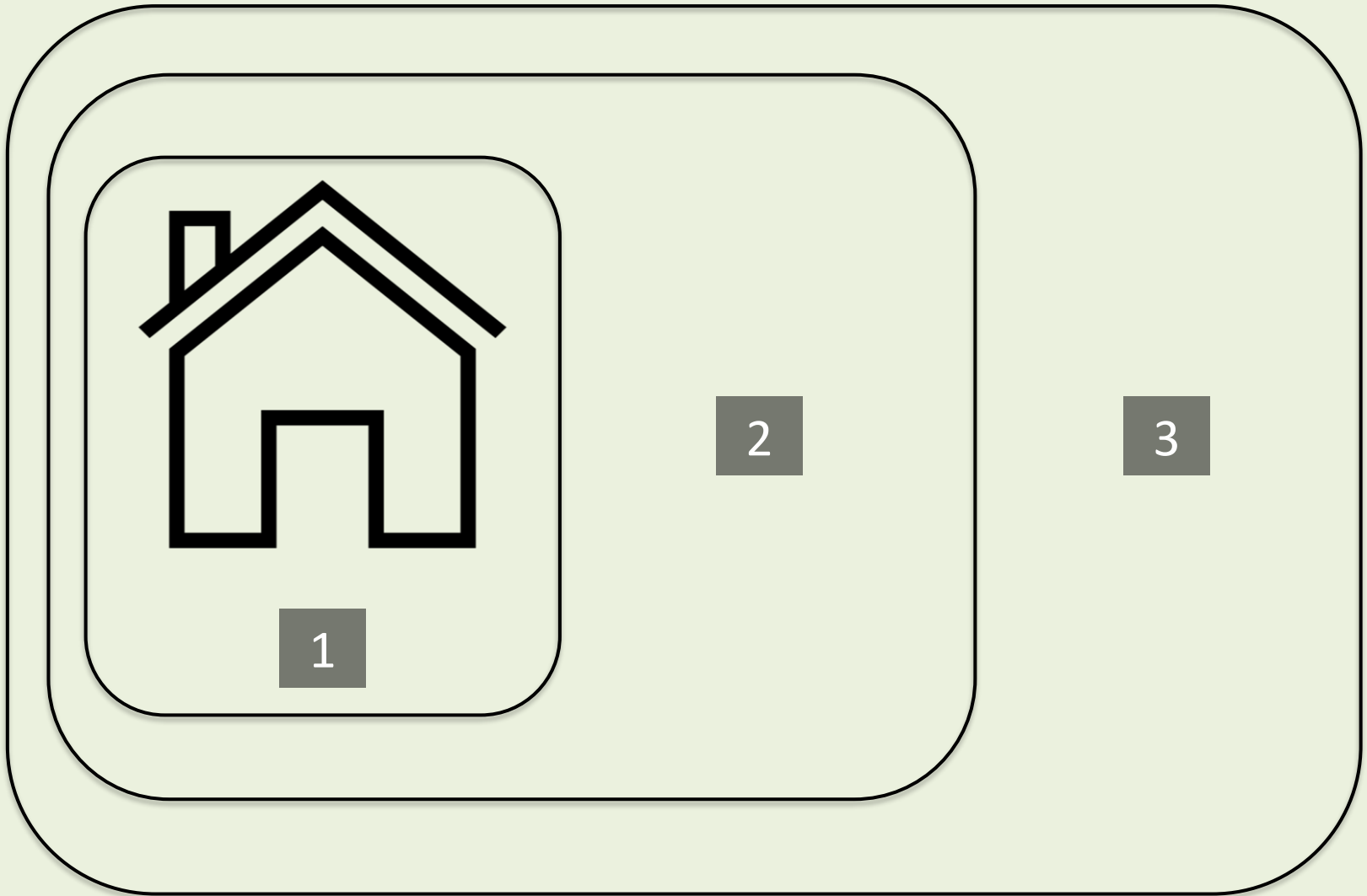

Zones

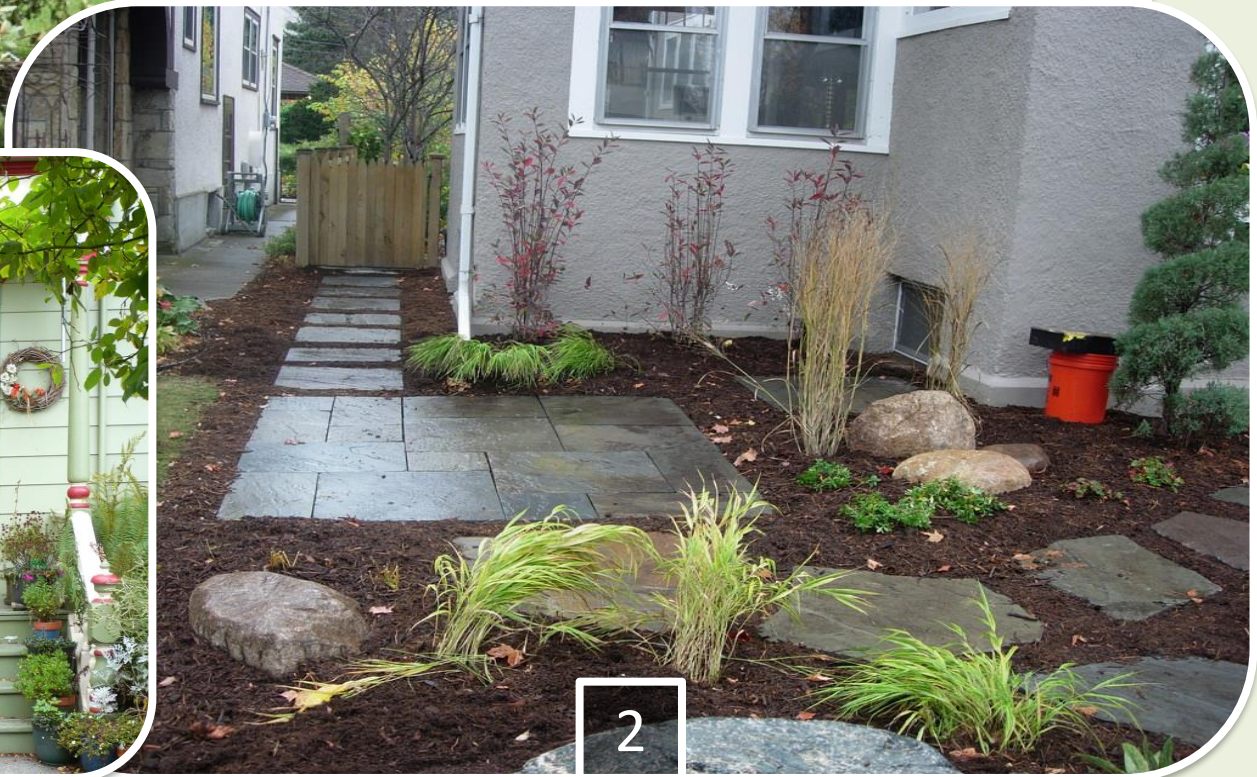

ALLEY

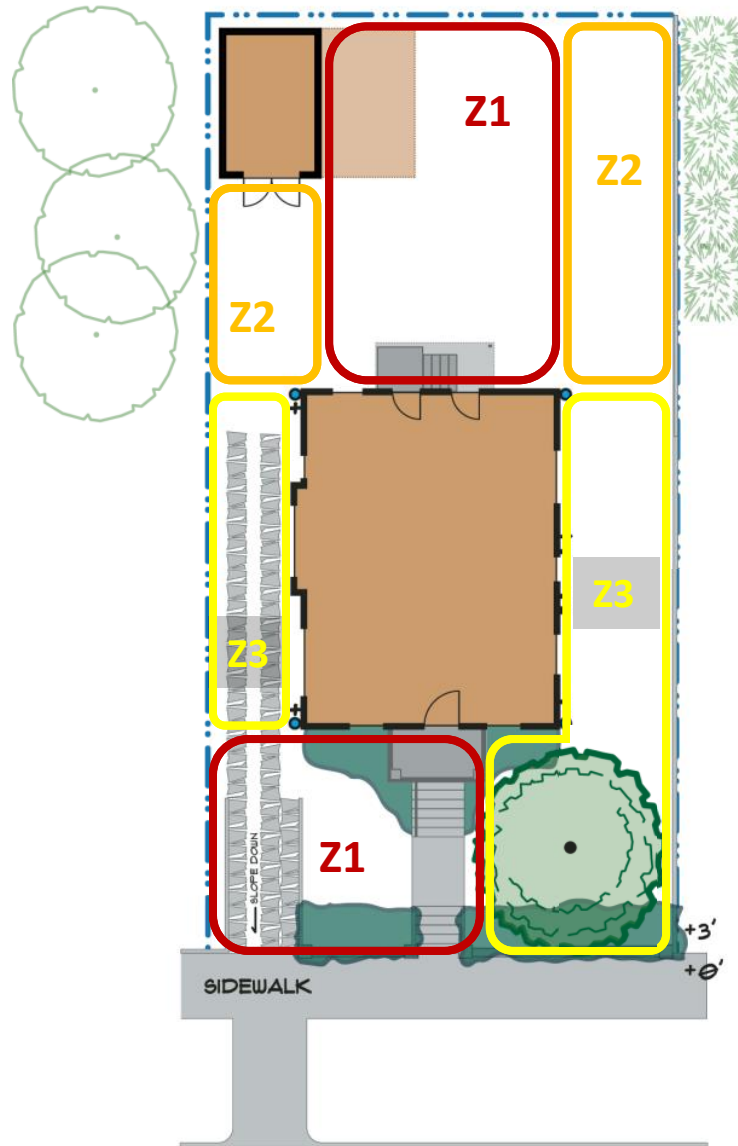

SITE ASSESSMENT: ZONES

1' 5' 10'



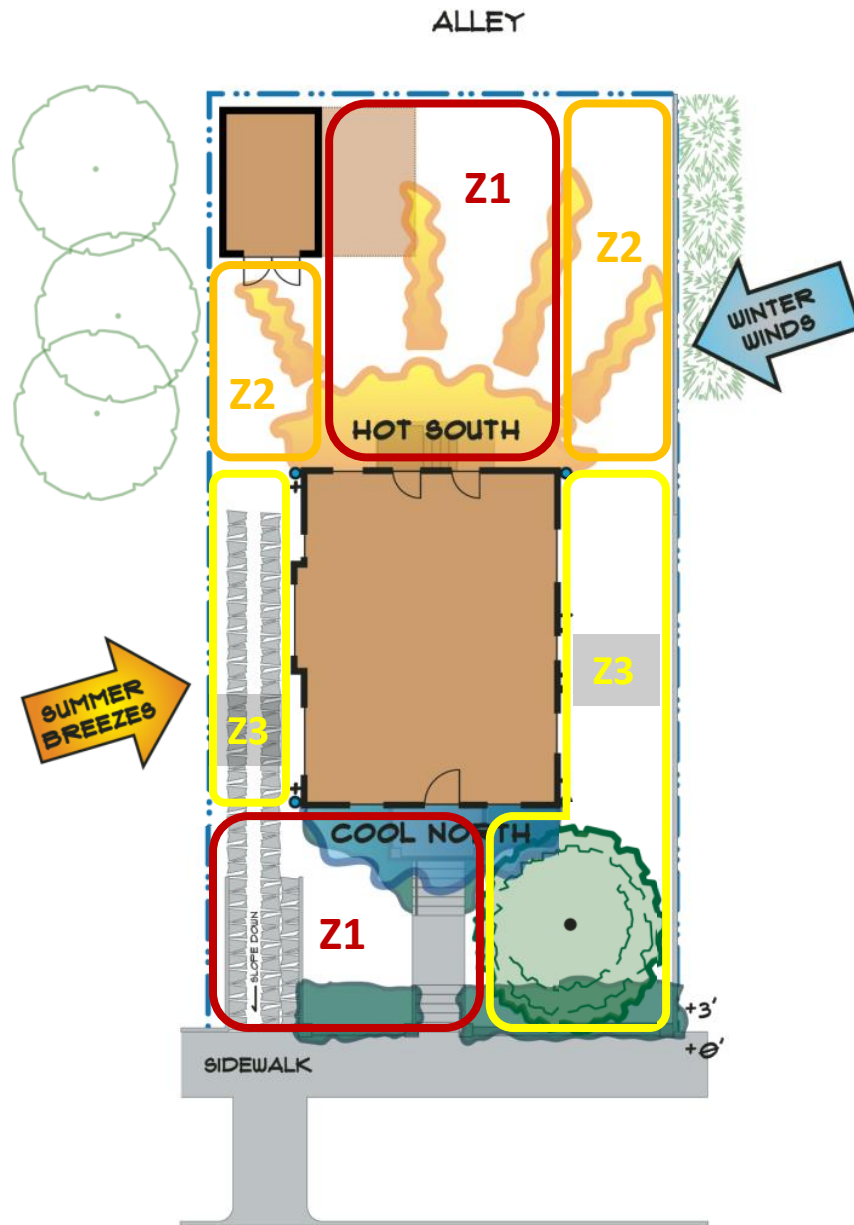

SITE ASSESSMENT: ALL FACTORS

1' 5' 10'





DESIGN OPPORTUNITIES

1' 5' 10'



Elements of an Edible Landscape

Site assessment

Edible plants by type & zone

Planning for abundance

Break

Soil & water

Integrated pest management

Beneficial insects & companion planting

Annuals (Zone 1)

Harvested the same year they are planted:



Broccoli



Tomatoes and collards



Summer squash

Beans -- Carrots -- Kale -- Lettuce -- Peas -- Potatoes -- Tomatillos

Annuals (Zone 1)



Tomatoes

*Bartelly, Green Zebra, Indigo,
Gold Metal, Kellogg's Breakfast*

Beans

Capitano, Dragons Tongue, Sunshine

Cabbage

Deadon, Red Express, Ruby Ball

Cauliflower

Cheddar, Flame Star, Graffiti, Romanesco

Eggplant

Annina, Barbarella, Fairy Tale, Ping Tung

Swiss chard

Bright Lights, Peppermint, Rhubarb

Herbs & Edible Flowers (Zones 1 & 2)

May be annual or perennial. May be woody or herbaceous.



Nasturtium



Rosemary and sage

Basil -- Borage -- Cilantro -- Fennel -- Mint -- Oregano -- Thyme

Herbs & Edible Flowers (Zones 1 & 2)



Layer different textures -- Echo similar colors

Perennials (Zones 2 & 3)

May be woody or herbaceous.



Asparagus -- Currants -- Grapes -- Huckleberry -- Rhubarb

Fruit & Nut Trees (Zone 3)

Perennial. Trees that bear edible nuts, berries, fruit, or flowers.



Apples



Figs

Cherry -- Hazelnut -- Pear -- Persimmon -- Quince -- Walnut

Perennials & Fruit Trees

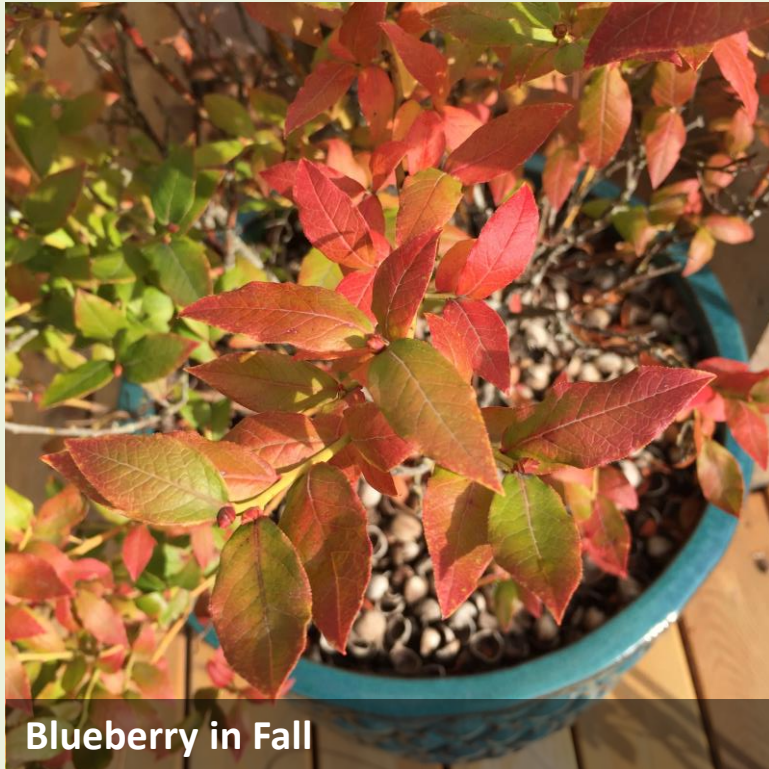

Blueberry in Fall

Attractive Blooms

Apple, Aronia, Artichoke, Bush Cherry, Cornelian Cherry, Pear, Plum, Quince

Colorful Fruit

Cornelian Cherry, Goumi, Currant, Persimmon, Pomegranate

Fall Color

Aronia, Asparagus, Blueberry, Jujube, Pawpaw

Evergreen Foliage

Feijoa, Evergreen Huckleberry, Himalayan Huckleberry, Lingonberry, Loquat, Salal

Edible Pacific NW Natives

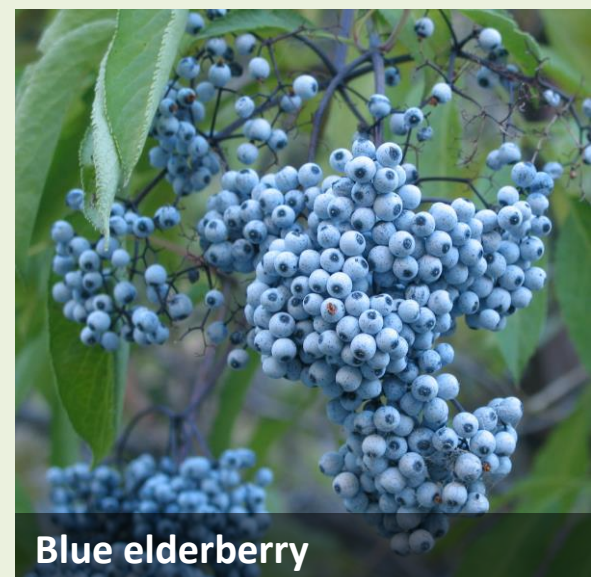

Elements of an Edible Landscape

Site assessment

Edible plants by type & zone

Planning for abundance

Break

Soil & water

Integrated pest management

Beneficial insects & companion planting

Create a Wishlist

EDIBLE LANDSCAPING WISH LIST

Fruits, veggies, and herbs that you enjoy eating:

Fresh foods you buy often from the grocery store:

Things you know you'll want to do with your harvested crops:

(examples: pickling, making jam or jelly, daily salad for lunch, fresh after-school snacks, etc.)

Fruits, veggies, and herbs that you're curious to try:

Diversify to extend your harvest



Overwintered kale



Onions for storage



Rhubarb for jams and sauce



Sunchokes for a fall harvest

Plant again and again

Succession planting: planting *short and half-season* crops multiple times per year.

4' x 4' BED
1st planting - Spring

4'	Radishes			
3'	Carrots			
2'	Mustard greens			
1'	Beets			
0'	1'	2'	3'	4'

4' x 4' BED
2nd planting - Summer

4'	Tomatoes				
3'					
2'	Peppers		Eggplant		
1'	Basil				
0'	1'	2'	3'	4'	

Plan for Fall and Winter

Fall crops: plant in late summer for a fall harvest.



*Arugula -- Beets -- Cilantro -- Leaf lettuce -- Kohlrabi
Mustard greens -- Radishes -- Spinach -- Turnips*

Plan for Fall and Winter

Overwintering crops: plant frost-tolerant crops in late summer or early fall for winter or early spring harvest.



Cabbage -- Collards -- Kale -- Leeks -- Mustard greens

Elements of an Edible Landscape

Site assessment

Edible plants by type & zone

Planning for abundance

****Break****

Soil & water

Integrated pest management

Beneficial insects & companion planting

Elements of an Edible Landscape

Site assessment

Edible plants by type & zone

Planning for abundance

Break

Soil & water

Integrated pest management

Beneficial insects & companion planting

What makes great garden soil?

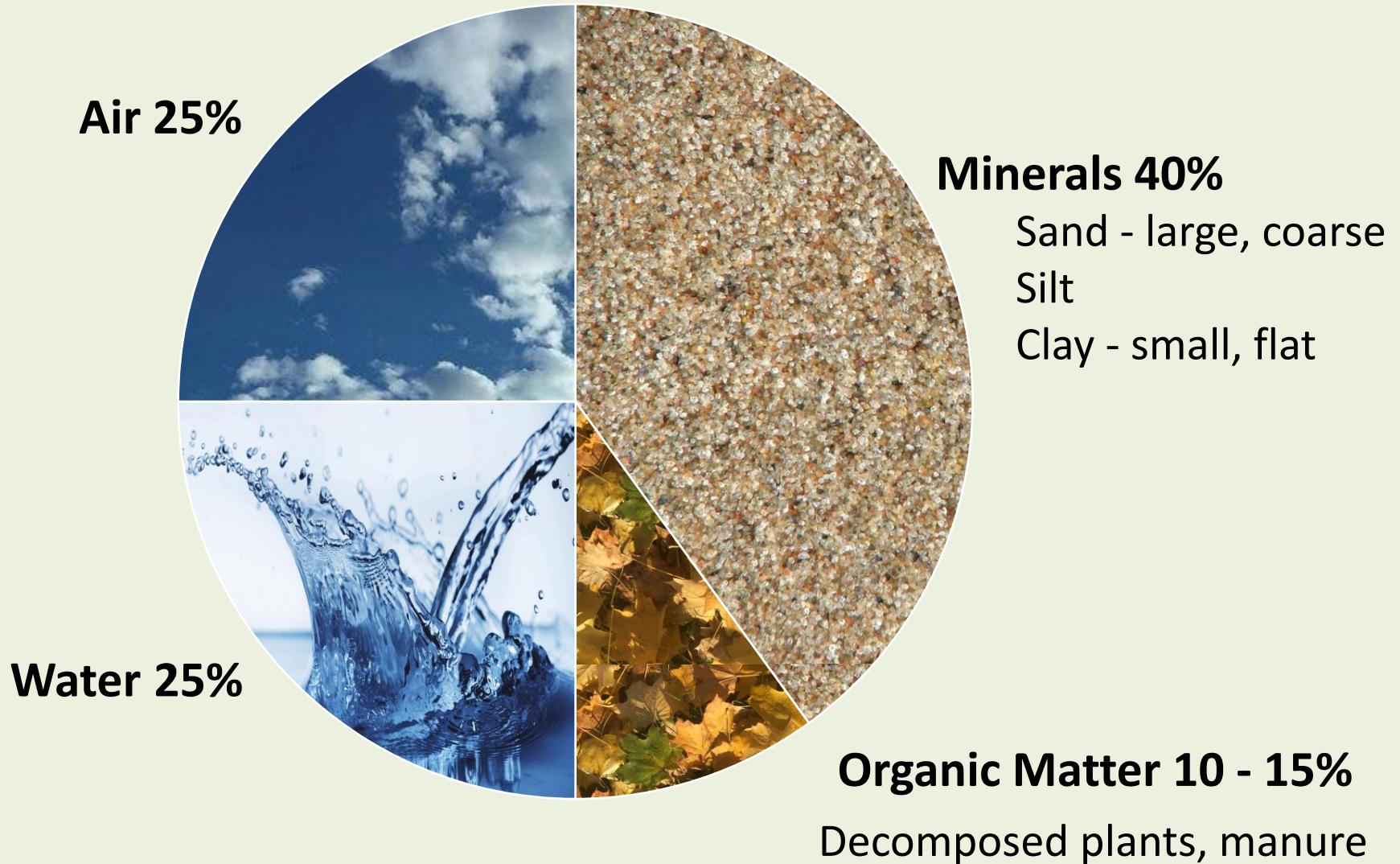

Building Healthy Soil

1. Plant waste fed to livestock or composted



2. Organic matter added to beds, feeds soil life

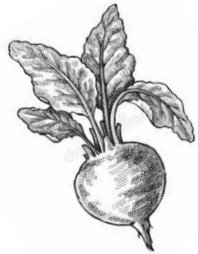
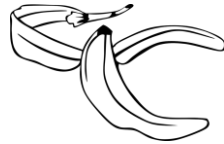

4. Plant roots take up available nutrients, water

3. OM broken down by worms, bacteria, fungi, etc.

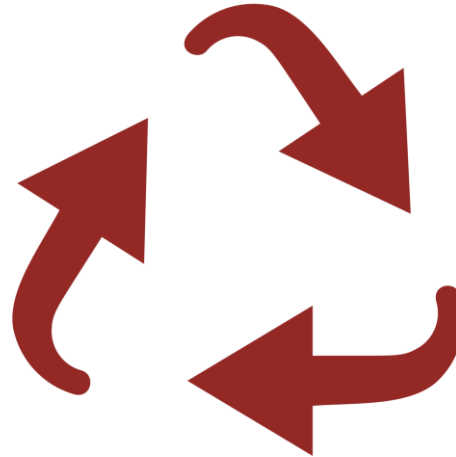
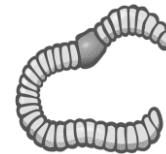

Be Smart About Water



Be Smart About Water



Water catchment system

Be Smart About Water



Water directed to rain garden

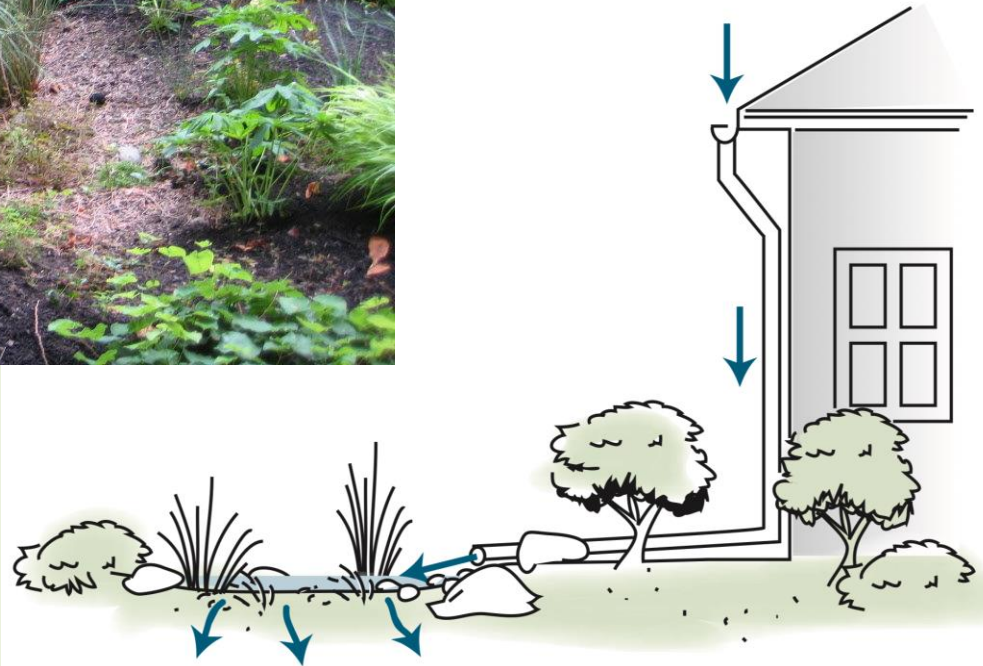

FREE Rain Garden
workshop at emswcd.org

Elements of an Edible Landscape

Site assessment

Edible plants by type & zone

Planning for abundance

Break

Soil & water

Integrated pest management

Beneficial insects & companion planting

Integrated Pest Management (IPM)



Systematic approach to prevent/minimize problems
using **least harmful methods first.**

1) Planning / Prevention



2) Physical removal / Barriers



3) Purchased predators / Bt



4) Chemicals (*including organic!*)



Elements of an Edible Landscape

Site assessment

Edible plants by type & zone

Planning for abundance

Break

Soil & water

Integrated pest management

Beneficial insects & companion planting

Beneficial Insects & Wildlife

Adult lady beetles can feed on nectar



BABY LADYBUG!



Lady beetle larva eat aphids

FREE Beneficial Insect workshop at emswcd.org

Beneficial Insects & Wildlife

Food & Water

Multiple seasons

Plant diversity



Rocks = safer access to water

Overwintering

Multiple layers

Leave the leaves!



Many insects overwinter in yard debris

Pacific NW Natives for Habitat

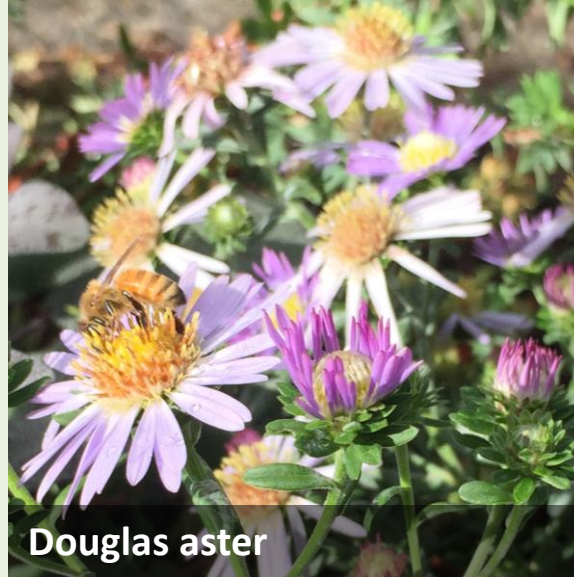

Companion Planting

Increase plant diversity to create mutually beneficial ecosystem.

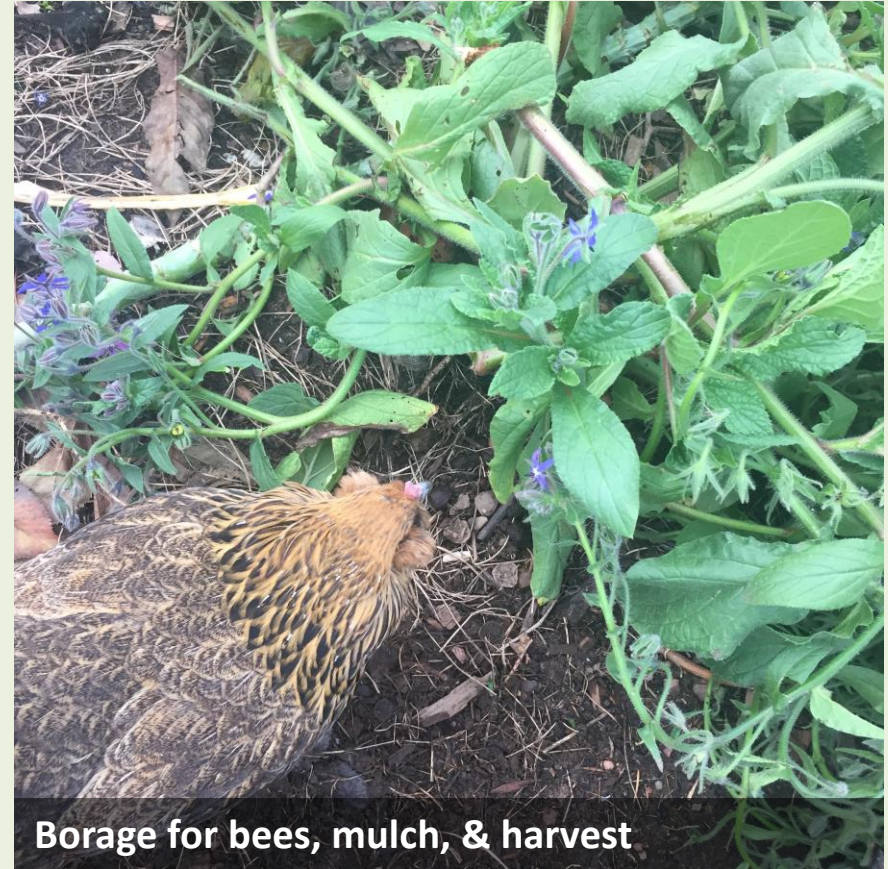

Alyssum -- Borage -- Calendula -- Chives -- Marigold -- Scabiosa

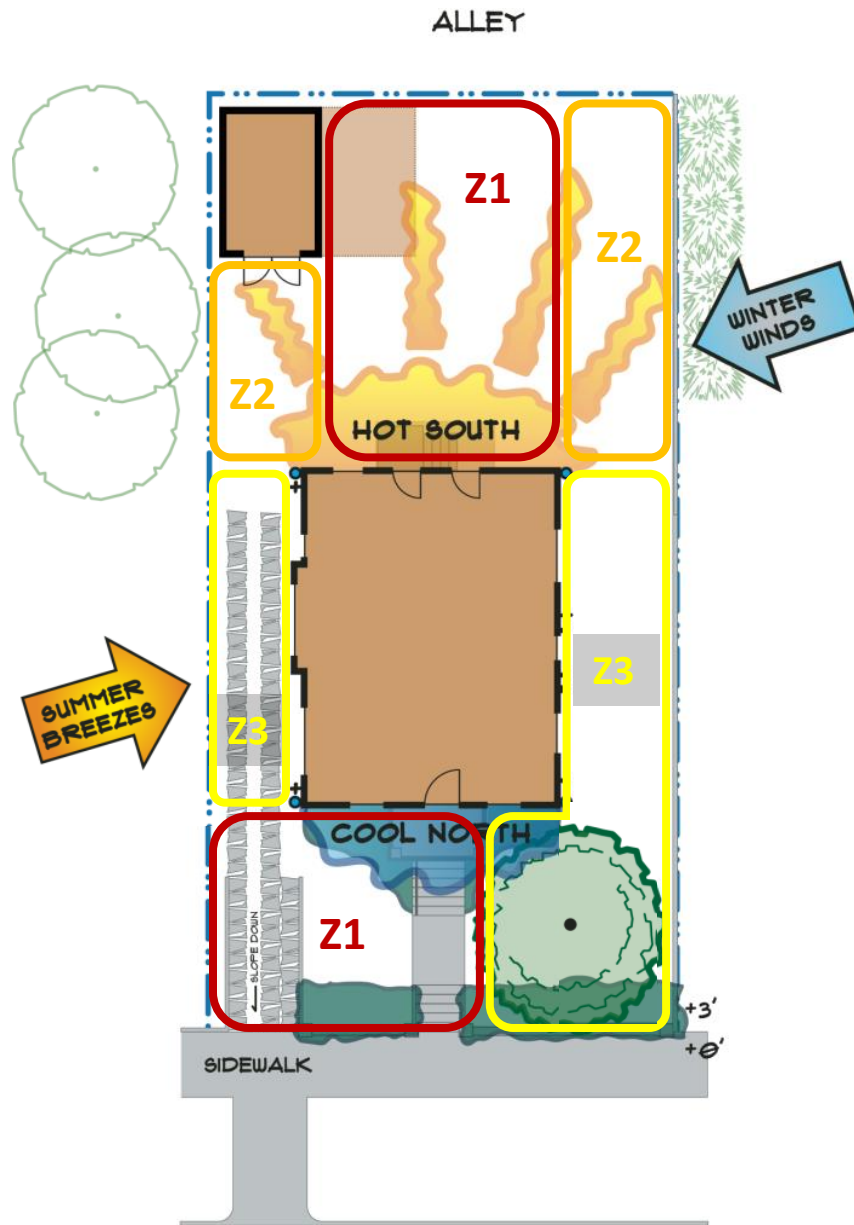

SITE ASSESSMENT: ALL FACTORS

1' 5' 10'





DESIGN OPPORTUNITIES

1' 5' 10'





"To plant a garden is to believe in tomorrow."
-- A. Hepburn

EMSWCD Conservation Directory:



Landscaping for people, water and wildlife.

ABOUT EMSWCD	IN YOUR YARD	ON YOUR LAND	GRANTS AND COST SHARE	LAND CONSERVATION	FARM INCUBATOR	NATIVE PLANTS	WORKSHOPS AND EVENTS
-----------------	-----------------	-----------------	--------------------------	----------------------	-------------------	------------------	-------------------------

[EMSWCD](#) » [Home](#)

What is EMSWCD?

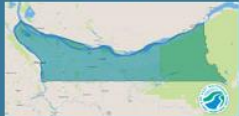

Learn more about East Multnomah Soil and Water Conservation District: who we are, where we work and what we do!

Find the services you need in our Conservation Directory!



Whether you need native plants or some design help, soil testing or weed control, chances are you'll find it in our Conservation Directory!

 **Conservation Directory**

The East Multnomah Soil and Water Conservation District (EMSWCD) is a unit of local government serving Northwest Oregon's Multnomah County east of the Willamette River. We work entirely on a voluntary, non-regulatory basis. All of our work is geared toward keeping water clean, conserving water and keeping soil healthy!

Upcoming EMSWCD Board and Committee Meetings

The East Multnomah Soil and Water Conservation District (EMSWCD), serving all of Multnomah County East of the Willamette River, has scheduled Board meetings and Grants, Land Legacy and Personnel Committee meetings at the District Office (5211 N. Williams Ave, Portland, OR 97217) for the months of September through December 2018.

[Visit this page](#) to see a calendar of upcoming meetings.

[September 27, 2018](#)

Register for a free workshop

Our fall season of workshops is here! We offer free and practical how-to workshops at a variety of locations in collaboration with our community partners. Discover simple gardening practices that will help you create a beautiful landscape that conserves water, reduces pollution



Presentation available online:

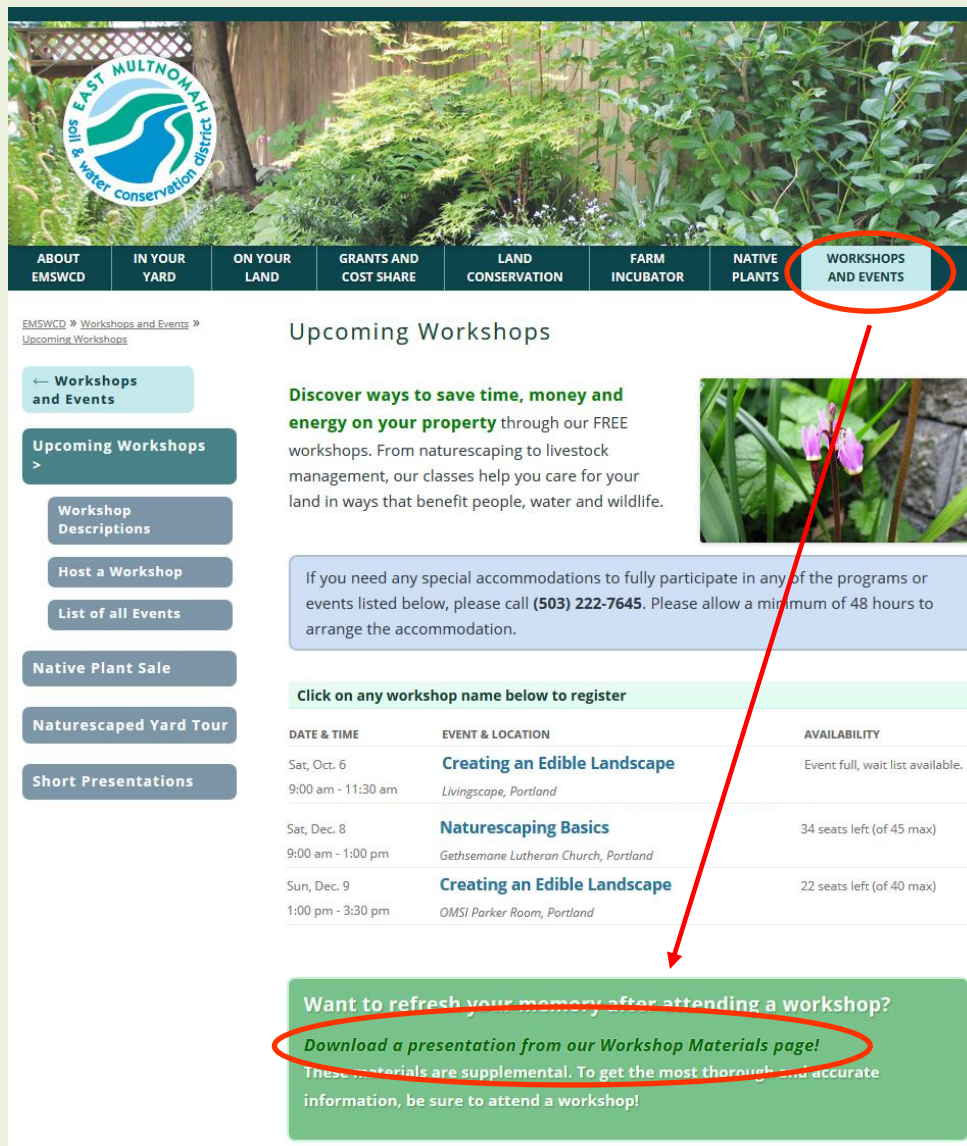

WORKSHOPS AND EVENTS

EMSWCD » Workshops and Events » Upcoming Workshops

← Workshops and Events

Upcoming Workshops >

Workshop Descriptions

Host a Workshop

List of all Events

Native Plant Sale

Naturescaped Yard Tour

Short Presentations

Upcoming Workshops

Discover ways to save time, money and energy on your property through our FREE workshops. From naturescaping to livestock management, our classes help you care for your land in ways that benefit people, water and wildlife.



If you need any special accommodations to fully participate in any of the programs or events listed below, please call (503) 222-7645. Please allow a minimum of 48 hours to arrange the accommodation.

Click on any workshop name below to register

DATE & TIME	EVENT & LOCATION	AVAILABILITY
Sat, Oct. 6 9:00 am - 11:30 am	Creating an Edible Landscape <i>Livingscape, Portland</i>	Event full, wait list available.
Sat, Dec. 8 9:00 am - 1:00 pm	Naturescaping Basics <i>Gethsemane Lutheran Church, Portland</i>	34 seats left (of 45 max)
Sun, Dec. 9 1:00 pm - 3:30 pm	Creating an Edible Landscape <i>OMSI Parker Room, Portland</i>	22 seats left (of 40 max)

Want to refresh your memory after attending a workshop?

Download a presentation from our Workshop Materials page!

These materials are supplemental. To get the most thorough and accurate information, be sure to attend a workshop!

Attend other EMSWCD workshops!

Learn how to create natural landscapes that
conserve water, reduce pollution, and
attract beneficial wildlife!

Pollinators

Native Plants

Beneficial Insects

Naturescaping

Rain Gardens

Invasive Urban Weeds

www.emswcd.org



Tell your friends and neighbors!



www.emswcd.org/workshops

